

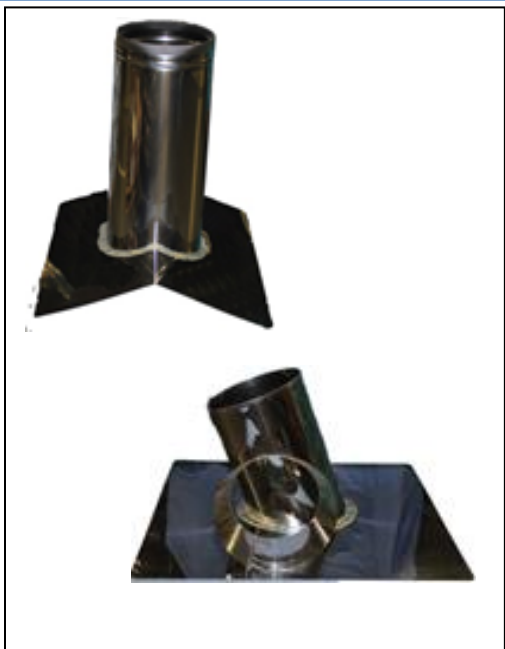

LEADER Customized Roof Jack



Leader Evaporator Co., Inc.

49 Jonergin Drive

Swanton, Vermont 05488

(802) 868-5444

www.leaderevaporator.com

Contents

INTRODUCTION.....	3
EQUIPMENT DESCRIPTION.....	3
ORDERING INFORMATION.....	4
INSTALLATION.....	5
FEEDBACK.....	8

INTRODUCTION

A Leader roof jack is designed to allow easy and leak resistant covering of the roof penetration for stacks used in evaporator operations.

EQUIPMENT DESCRIPTION

Roof Jacks are available in two different styles and two different materials. The styles of roof jack are; LEADER water tight (recommended for smoke stacks) and GRIMM with rain collar (recommended for steam stacks having a hood installed). Both styles are available in either stainless steel or galvanized.



LEADER style peak mount roof jack also available in side mount



GRIMM style side mount roof jack also available in peak mount

ORDERING INFORMATION

When ordering a roof jack you will need to provide the following information;

Style – LEADER or GRIMM

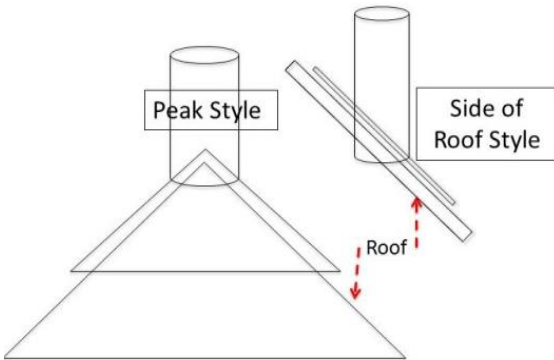

1. Material – Stainless steel or galvanized
2. Location of the mounting – peak of roof or side of roof

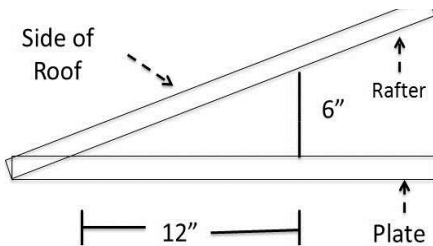

1. Run is measured as 12"
2. Rise is measured as 6"
3. Pitch is 6/12.

3. The pitch of the roof
 - a. Pitch of the roof is defined as the rise (change in vertical distance) of the roof over the run (change in horizontal distance) of the roof.
 - b. Measure a distance along one of the rafter plates. For that same distance, measure the distance *change* between the rafter plate and the rafter. Ensure you use the same units of measure (ex. inches). Reference the example.

INSTALLATION

NOTE: The following information is pertaining to setup and is to be considered one suggested method. Installations should meet all applicable governmental regulations and standards.

1. Prepare a template to be used to cut a hole in the roof around which the roof jack will be mounted. Obtain a piece of material larger than the opening in the bottom of the roof jack and sturdy enough to be handled on the roof.

OPTIONALLY: Use the roof jack as a pattern and mark the roof with a marker.

2. Place the template material against the bottom of the roof jack. If you are using a peak style, form the template material to the "V" of the roof jack.
3. Cut the template material following the opening of the hole in the bottom of the roof jack.

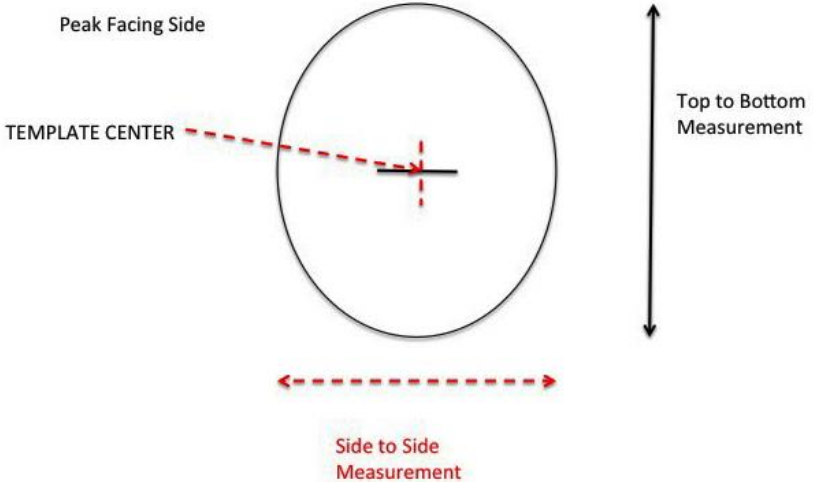

4. Mark the center of the template then make a small hole in the center (approximately the size common nail). For a peak style, find the center of the fold line of the “V”. A side of roof style will have an oval hole. For a side of the roof style you will need to measure from top to bottom, mark the template with a straight line going through the center. Then measure side to side and mark the template with a line going through the center. The center of the template is where the two lines intersect.
5. For a side of roof style roof jack, mark the side of the template that should face the peak side of the roof.
6. Locate the mark on the underside of the roof made when you measured for the roof jack.
7. Drill a hole through the roof, at the mark, the same size as the hole you made in the center of the template.
8. Take the template to the roof. Place the center hole of the template over the hole drilled in the roof. You can insert something through the holes to hold the template in place.

9. Mark the roof a minimum of 2” out from and around the template. Refer to the applicable governmental regulations as to minimum clearances required dependent on materials of roof construction. Remove the template. The outline marked on the roof is the cut line for installation of the roof jack. Cut along the line. Ensure you have enough support for the roof prior to cutting.
10. Place the roof jack on the roof centering the hole in the roof jack with the hole in the roof.
11. Secure the roof jack in place ensuring it is waterproof to prevent leaks.

The following section describes one possible method for securing a roof jack to a corrugated roof.

NOTE: If the roof jack is a side mount and close to the ridge of a corrugated roof, slide the roof jack under the ridge and screw down on top of the corrugations to give more air flow and cooling.

- a. Prepare the hole in the roof as described in the previous sections.
- b. Obtain metal roofing self adhering tape seal and secure to the underside outside edges of the roof jack.
- c. Mount and secure the roof jack as described in the previous sections. Ensure you have a complete seal with the tape seal around the roof jack.
- d. Obtain a piece of the corrugated roofing material long enough to be placed under the peak ridge cap to beyond the bottom edge of the roof jack. This piece of roofing will be placed over the roof jack.
- e. Determine where the roof jack will penetrate the new piece of roofing and cut out the necessary hole.
- f. Place the piece of roofing over the roof jack and under the peak ridge cover. Secure the roofing in place.

Additional Items to Consider:

- If you are mounting to a corrugated roof and you cannot slide a piece of roofing under the ridge cap as described, a method might be to slit the roofing the width of roof jack and slide the roof jack under the slit (lining the stack hole up as described above). Then seal all edges paying particular attention to where the slit was made to the roof.
- When using a peak style roof jack, mount the roof jack under the ridge cap.
- When using self tapping roofing screws, pre-drill the roof jack as the screws will not penetrate the roof jack if it is stainless steel.

FEEDBACK

Please use the following e-mail address

(feedback@leaderevaporator.com) to suggest improvements or enter comments on this document. Reference the document title in your note. You may also contact LEADER Customer Service.